

LOW BASE - MAXIMUM VIEW - MULTI-PURPOSE 35E SERIES – ENDLESS DESIGN 78.5" HEIGHT



R-OD35E-4-LB-B
*ARTIST RENDERING

| REMOTE MODEL NO. | DESCRIPTION | LENGTH | DEPTH | HEIGHT | VOLTAGE | AMPS | HB/ BTUS | POWER CORD | EST. SHIP WEIGHT |
|---------------------|-------------|--------|--------|--------|---------|------|-------------|---------------|---------------------|
| R-OD35E-4-LB-B | Remote | 51.00" | 34.50" | 78.50" | 115 | 3.0 | 7238 | NO | 790 |
| R-OD35E-6-LB-B | Remote | 75.00" | 34.50" | 78.50" | 115 | 4.0 | 10813 | NO | 1040 |
| R-OD35E-8-LB-B | Remote | 99.00" | 34.50" | 78.50" | 115 | 6.0 | 14083 | NO | 1580 |

(ALL WHITE OR ALL BLACK, NO EXTRA CHARGE—IF COLORS ARE MIXED AN ADDITIONAL CHARGE WILL APPLY)

| Prefix | Suffix |
|---------------------|---------------------|
| SC = Self Contained | B = Black |
| R = Remote | W = White |
| | S = Stainless Steel |
| | LED = LED lighting |

- Cases are designed to operate at 75 degrees Fahrenheit and 55% relative humidity
- Cases are equipped with drains; check your local building codes for connection requirements.
- Specification subject to change without notice



Howard McCray • 831 East Cayuga St • Philadelphia, PA 19124 USA • (215) 464-6800
1-800-344-8222 • Fax (215) 969-4890 • E-Mail: sales@howardmccray.com • www.howardmccray.com

LOW BASE - MAXIMUM VIEW - MULTI-PURPOSE 35E SERIES ENDLESS DESIGN 78.5" HEIGHT

STANDARD SPECIFICATIONS AND OPTIONAL FEATURES

CONSTRUCTION

- UL Classified to ANSI/NSF 7
- Foamed in place CFC free foam
- Heavy gauge steel super structure
- Multi deck
- Endless design allows for continuous line up

INTERIOR

- Black end panels
- Removable black floor pans
- Black perforated rear wall (for even air distribution)
- Full length lighting at top of unit
- 4 levels of lighted shelving
- 5 levels of product display
- Price tag molding on each shelf

EXTERIOR

- Black ends and front finish
- 1" bumper
- Straight side end panels with 16" plexiglass

LIGHTING

- 1 row at inside top of unit
- 4 rows of lighted shelving

ELECTRICAL REQUIREMENTS

- UL/CUL listed
- See Tech page for details on voltage

REFRIGERATION

- Low velocity fans located below deck area (to insure even flow of air)
- Solenoid valve
- New high efficiency air screen technology

OPTIONAL FEATURES

- Night covers
- Product stops on shelving
- Digital thermometer
- Condensate pan and pump kit

IMPORTANT NOTE:

ALL REFRIGERATED CASES ARE DESIGNED TO OPERATE IN AN ENVIRONMENT OF 75 DEGREES AND 55% RELATIVE HUMIDITY.

PRODUCT MUST BE COOLED BEFORE BEING DISPLAYED WITHIN THE CASE.

DRAIN IS REQUIRED

LOW BASE - MAXIMUM VIEW - MULTI-PURPOSE 35E SERIES ENDLESS DESIGN 78.5" HEIGHT

TECHNICAL DATA

| MODEL NO. | | R-OD35E-4-LB-LED | R-OD35E-6-LB-LED | R-OD35E-8-LB-LED |
|----------------------------|-------------|------------------|------------------|------------------|
| Length with (2) ends | | 51" | 75" | 99" |
| Length without ends | | 48" | 72" | 96" |
| Height with ends | | 78.5" | 78.5" | 78.5" |
| Height without ends | | 78" | 78" | 78" |
| Depth with ends | | 34.5" | 34.5" | 34.5" |
| Depth without ends | | 34.25" | 34.25" | 34.25" |
| Endless design | | YES | YES | YES |
| (Dimensions are +/- 1/4") | | | | |
| Operating temperature | | 36°F to 40°F | 36°F to 40°F | 36°F to 40°F |
| Defrost per day (24 hours) | Air Defrost | 6 per day | 6 per day | 6 per day |
| BTU's at +20°F Evap. Temp. | R | 7238 | 10813 | 14083 |
| Remote Voltage | R | 115 | 115 | 115 |
| Amperage, lights only | R | 3.0 | 4.0 | 6.0 |
| Cord and plug | R | No | No | No |
| Exterior color | | BLACK | BLACK | BLACK |
| Interior color | | BLACK | BLACK | BLACK |
| # of rows / shelves | | 4 / 4 | 4 / 8 | 4 / 8 |
| Shelf Size | | (4) 18" | (4) 18" | (8) 18" |
| Shipping Info | | | | |
| Height | | 86" | 86" | 86" |
| Depth | | 44" | 44" | 44" |
| Length | | 61" | 86" | 109" |
| Gross weight R | | 790 | 1040 | 1580 |
| Cubic feet | | 134 | 189 | 239 |

- Cases are designed to operate at 75 degrees Fahrenheit and 55% relative humidity
- Cases are equipped with drains; check your local building codes for connection requirements.
- Specification subject to change without notice

Howard McCray • 831 East Cayuga St • Philadelphia, PA 19124 USA • (215) 464-6800

1-800-344-8222 • Fax (215) 969-4890 • E-Mail: sales@howardmccray.com • www.howardmccray.com

LOW BASE - MAXIMUM VIEW - MULTI-PURPOSE 35E SERIES ENDLESS DESIGN 78.5" HEIGHT

DRAWINGS - SIDE VIEW - FRONT VIEW - PLAN VIEW

FRONT VIEW (SELF CONTAINED)

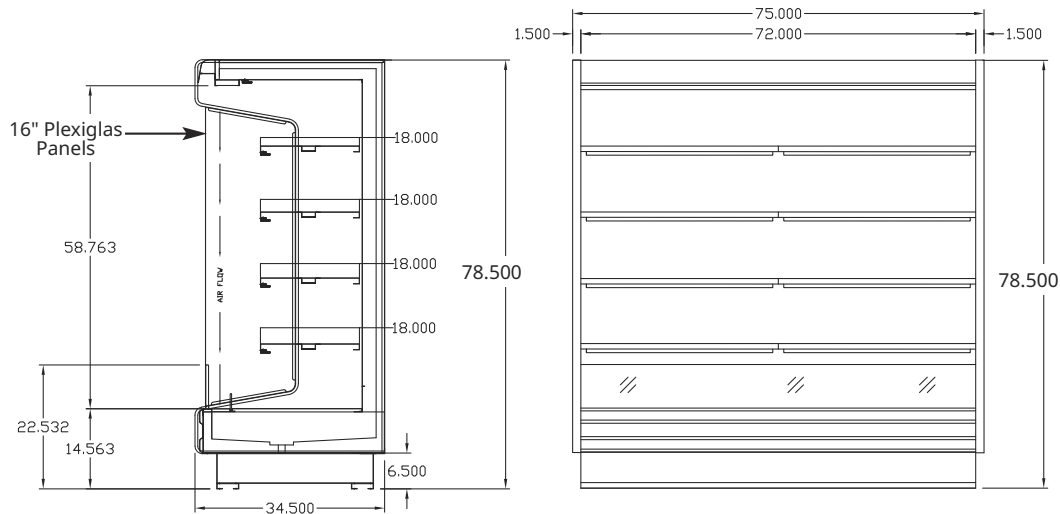

4' PLAN VIEW

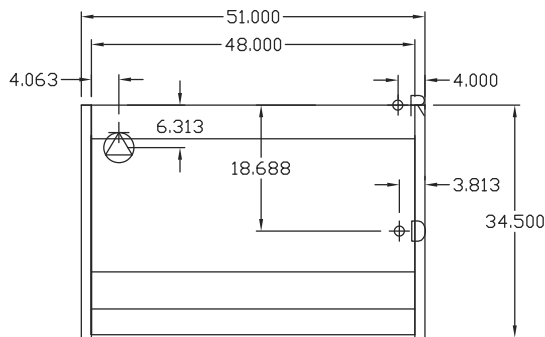

6' PLAN VIEW

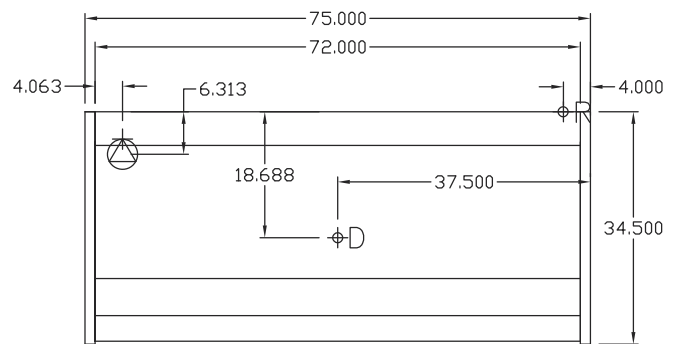

8' PLAN VIEW

